



ABRASION/MECHANICAL

# Expando® PFA

## Product Highlights

- Operating temperature from -70°C to +260°C (-94°F to +500°F)
- BMS 13-52 Type IV
- FAR Part 25
- Does not trap heat or humidity
- Rot-free
- Expandable design accommodates a variety of sizes

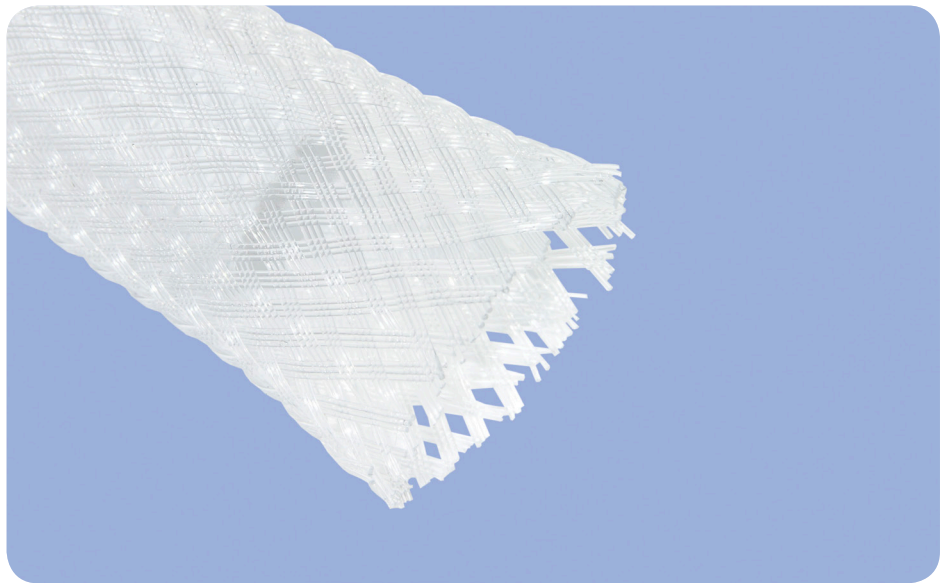

**Expando® PFA** is an expandable sleeve constructed of PFA (perfluoroalkoxy) that is designed for applications up to +260°C (+500°F). Expando PFA has low flammability and resists damage from most chemicals.

Expando PFA protective oversleeve is widely used in the aerospace industry for its high temperature capability and ability to retain flexibility at low temperatures.

Expando products are tough, lightweight oversleeves used to protect cable assemblies, hoses and wire harnesses from chafing, cutting and abrading. The open braid construction of Expando products enables each size to expand to fit several application shapes and diameters. This open textile construction also makes them highly flexible and resistant to trapping water, heat and humidity.



Our manufacturing sites are certified ISO 9000, QS 9000 or ISO/TS 16949 and ISO 14001

E\_EXPPFA\_10042010

**BentleyHarris®**  
Protection Products

 **FEDERAL  
MOGUL**  
Systems Protection

 **iS Rayfast**

# Performance Data – Expando® PFA

Property	Test Method	Result
Operating Temperature		-70°C to +260°C (-94°F to +500°F)
Melt Temperature	ASTM D-3418	+302°C
Low Temperature Flexibility	MIL-DTL-23053E	-70°C
Flammability	FAR Part 25	Pass
Smoke Density	ASTM E-662	No smoke/No ignition
Hard Vacuum TML CVCM	ASTM E-595	Meets industry limits: 1.0% max 0.1% max
Fluid Resistance Jet Fuel JP-4 (MIL-T-5624) Hydraulic Fluid (MIL-H-5606) Lube Oil (MIL-I-7808) De-Ice Fluid (MIL-A-8243) Reference Oil #2 (ASTM D-471) Salt Water (O-S-1926)	MIL-DTL-23053 24 hour immersion	No visible degradation Maintains >80% tensile strength

## Product Specifications

Longitudinal shrinkage should be taken into account when utilizing expansion properties of the sleeve

Commercial Part Number	Recommended Application Range mm (in)		Maximum Weight g/m (lb/ft)	Standard Packaging m (ft)
	Min Ø	Max Ø		
Expando PFA 3-9	1 (1/32")	6 (1/4")	7.9 (0.0053)	610 (2,000')
Expando PFA 6-9	2 (1/16")	11 (7/16")	10.8 (0.0073)	305 (1,000')
Expando PFA 10-9	5 (3/16")	16 (5/8")	33.7 (0.0226)	152 (500')
Expando PFA 13-9	8 (5/16")	19 (3/4")	40.8 (0.0274)	152 (500')
Expando PFA 19-9	10 (3/8")	25 (1")	50.6 (0.0340)	152 (500')
Expando PFA 32-9	16 (5/8")	38 (1-1/2")	82.2 (0.0552)	76 (250')
Expando PFA 45-9	17 (11/16")	51 (2")	101.3 (0.0680)	76 (250')
Expando PFA 51-9	19 (3/4")	76 (3")	144.4 (0.0970)	76 (250')

## Part Numbering System

Example	Product Name	Size	Color	Quantity
	Expando PFA	19	9 (natural)	152m

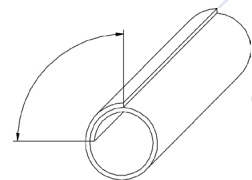

The information and illustrations given herein are believed to be reliable. Federal-Mogul makes no warranties as to their accuracy or completeness and disclaims any liability in connection with their use. Federal-Mogul's only obligations are those in the standard term of sale for this product and Federal-Mogul will not be liable for any consequential or other damages arising out of the use or misuse of this product. Users should make their own evaluations to determine the suitability of the product for specific applications.

©2008 Federal-Mogul Systems Protection, manufacturer of Bentley-Harris protection products.



Tel: +44(0) 1793616700 • Fax: +44(0) 1793 644304  
uksales@is-rayfast.com • export@is-rayfast.com

[www.is-rayfast.com](http://www.is-rayfast.com)

2 Lydiard Fields, Swindon, Wiltshire, SN5 8UB

